

# Franklyn James



## Lowestoft Mews, , London, E16 2ST Asking Price £265,000

Offering a fantastic riverside location and river views, Franklyn James are proud to offer this spacious one bedroom property to the market. Located on the second floor with lift access, this property comprises an open plan living room and kitchen and direct access to a private balcony, along with a spacious double bedroom and bathroom. Further benefits include 24 hour security/estate office, well maintained communal grounds, and serviced elevator.

Galleons Lock is located in an area which has seen massive development in recent years and is within a 9 minute walk from King George V DLR Station.

- Balcony with river views
- Open plan kitchen & reception area
- 24 Hour Security/Estate Office
- One bedroom apartment
- Over 540 square meters
- Popular riverside development
- 9 minute walk from King George V DLR Station
- 175 years remaining
- £328.27 monthly for 10 months

Please contact our Limehouse Sales Office on 02077911777 if you wish to arrange a viewing appointment for this property or require further information.





Floor Plan

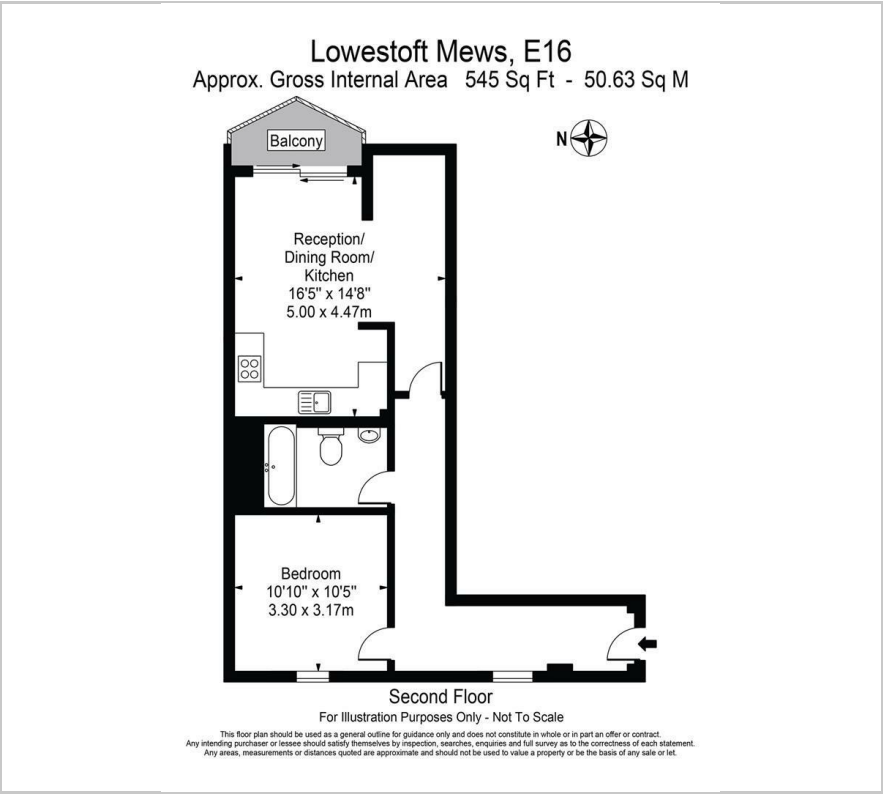

Area Map

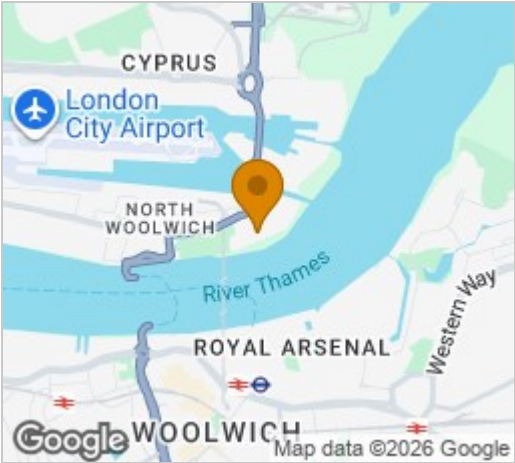

Energy Efficiency Graph

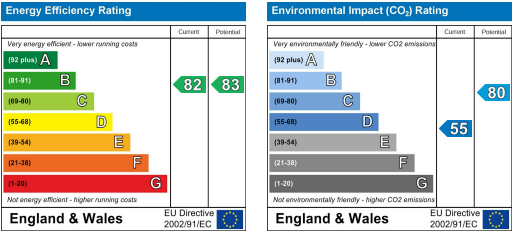

These particulars, whilst believed to be accurate are set out as a general outline only for guidance and do not constitute any part of an offer or contract. Intending purchasers should not rely on them as statements of representation of fact, but must satisfy themselves by inspection or otherwise as to their accuracy. No person in this firms employment has the authority to make or give any representation or warranty in respect of the property.